



Installation Instructions

Part No. 1950225

Quick Disconnect Mounting Plate

For all Hurst Quarter Stick® Shifters

Rev 02/26/2020

WORK SAFELY: Perform this on a good clean level surface for maximum safety and with the engine turned “off”. Apply parking brake and place blocks or wedges in front of and behind both rear wheels to prevent movement in either direction.

CAUTION: To avoid any possibility of bodily injury or damage to vehicle, do not attempt disconnect or installation until you are confident that the vehicle is safely secured and will not move.

This quick disconnect mounting plate allow the shifter to be installed and removed by simply inserting or withdrawing the quick release pins.

1. Fasten the quick disconnect mount to the floor of the vehicle with suitable fasteners.
2. If the optional cover kit is used, it must be fitted into position over the shifter. The shifter/cover assembly is then installed into the quick disconnect mounting plate.

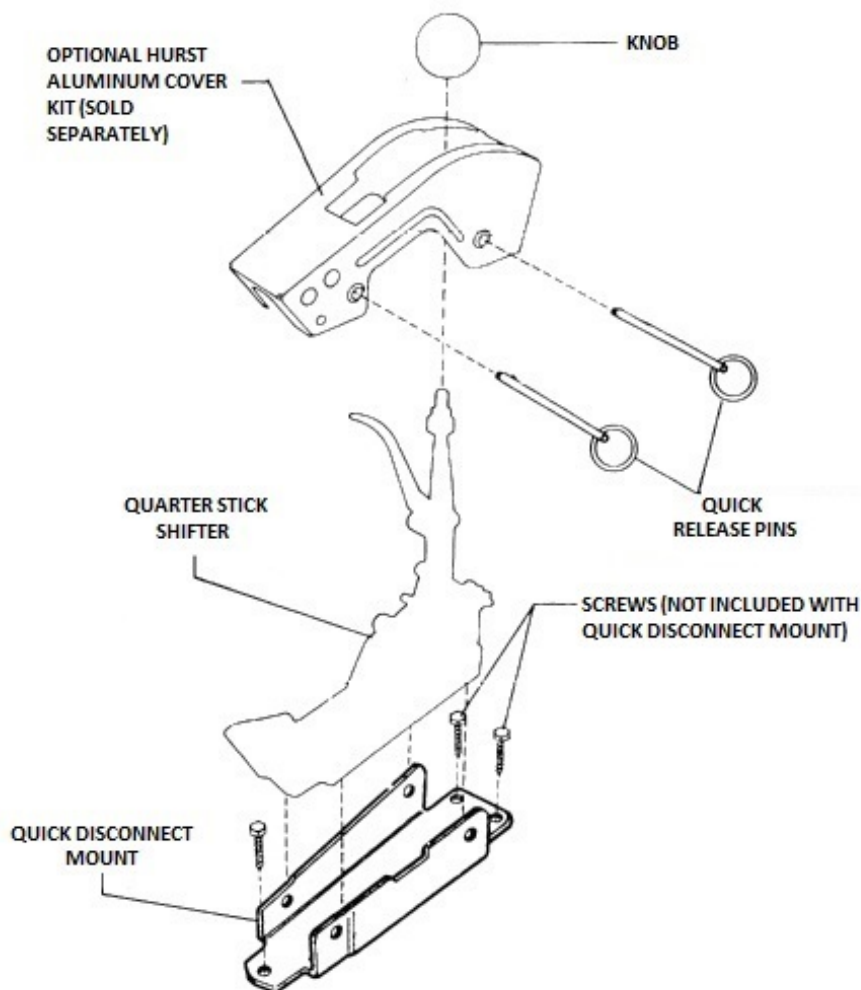

IMPORTANT: RETAIN THESE INSTRUCTIONS FOR FUTURE REFERENCE

Technical Service

Hurst Performance maintains a highly trained technical service department to answer your technical questions, provide additional product information and offer various recommendations.



Hurst Performance Products

(866) 464-6553

www.hurst-shifters.com